

SINGER

110W150

Form 1964w
(Rev. 154)
Printed in U. S. A.

LIST OF PARTS



SINGER**

MACHINE No. 110w150

THE SINGER MANUFACTURING COMPANY

From the library of: Superior Sewing Machine & Supply LLC

INSTRUCTIONS FOR OILING

To ensure easy running and prevent unnecessary wear of the parts which are in movable contact, the machine requires oiling and when in continuous use, "TYPE B" or "TYPE D" OIL, sold by Singer Sewing Machine Company, should be applied at least twice each day to all oil holes marked "OIL", as instructed in Form 1943w.

"TYPE D" OIL should be used when an oil is desired which will produce a minimum of stain on fabrics, even after a long period of storage.

Occasionally check the grease in gear case, fill when necessary, with GEAR LUBRICANT, sold by Singer Sewing Machine Company.

To insure satisfactory results, "TYPE E" Thread Lubricant, sold by Singer Sewing Machine Company, should be used in the thread lubricator which is attached to the top of the machine.

Oil the the bobbin case bearing in the hook race each time a bobbin is replaced.

INDEX

| | Page |
|------------------------------|------|
| Accessories | 14 |
| Bobbin Winder | 14 |
| Feed Regulating Gears | 15 |
| Foot Lifter | 15 |
| Machine No. 110w150..... | 5 |
| Numerical List of Parts..... | 19 |
| Roller Pressers..... | 16 |
| Work Plate Platform..... | 17 |

Copyright, U. S. A., 1925, 1938, 1939, 1940, 1950 and 1954,
by The Singer Manufacturing Company
All Rights Reserved for All Countries

INSTRUCTIONS FOR ORDERING

In ordering from this list, use ONLY the PART number in the FIRST column.

The number stamped on a Sewing Machine Part is the number of the Single Part only, except when the part includes Set Screws, Clamping Screws, Studs and Rollers Spun on, Small Wires riveted, or Parts soldered together, etc., which it is necessary to furnish in combination.

Every combination of parts sent out has its specific number which, although not stamped on Parts (except in above case), must be used when ordering the combination.

Each number always indicates the SAME PART in whatever list it appears, or for whatever Machine.

The letters after some of the numbers indicate the style of finish only, as follows:

- A Hardened, Polished, Nickel Plated and Buffed.
- AL Heat Treated for Toughness.
- B Polished, Nickel Plated and Buffed.
- C Hardened only.
- D Polished only.
- E Soft, Not polished.
- F Hardened and Polished.
- H Blued.
- J Nickel Plated only.
- R Merlized.
- X Black Oxide, for Iron and Steel.
- XC Hardened and Black Oxide, for Iron and Steel.
- Y Black Nickel Plated only.
- Z Chromium Plated.

These letters MUST BE USED when they appear in the list and AFTER the number, as in the list.

In this series

1 to 1500, 200001 to 201500 and 350001 to 351500 are Screw Numbers.
1501 to 1800, 201501 to 201800 and 351501 to 351800 are Nut Numbers.
1801 to 2000, 201801 to 202000 and 351801 to 352000 are Roller Numbers.
2001 to 50000 and 202001 to 350000 are Numbers of Machine Parts.

The figures in the second column refer only to the plate in which the illustration of the part is shown and are NOT TO BE USED in ordering.

Two or more numbers over a cut indicate that the difference between such parts is not visible in an illustration.

Parts marked with an asterisk (*) are furnished only when repairs are made at the factory.

LIST OF PARTS COMPLETE

FOR

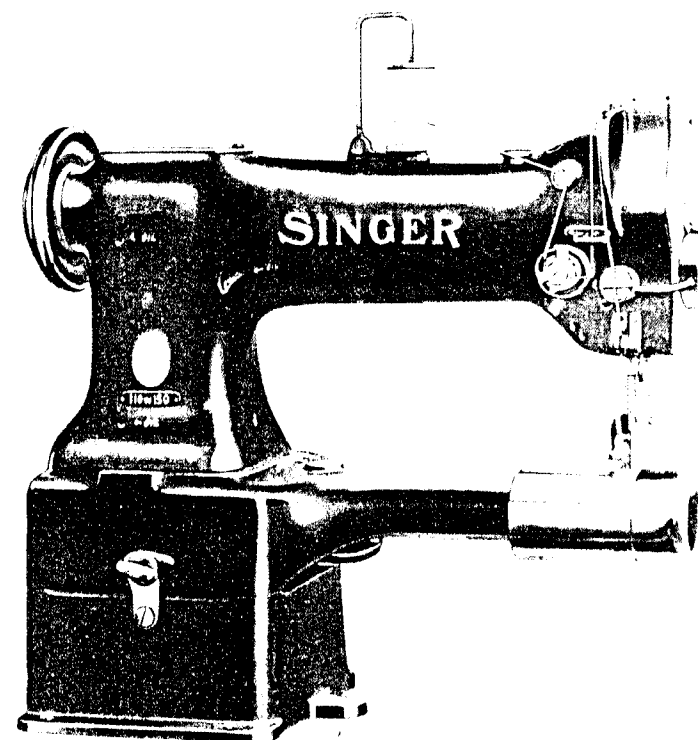

MACHINE No. 110w150

LEFT HAND CYLINDER MACHINE.

VERTICAL HOOK. ROLLER PRESSER.

HIGH SPEED. LOCK STITCH.

MAXIMUM STITCH 13 TO THE INCH.

FOR SHOES.

| No. | Plate | Name |
|---------|-------|---------------------------------|
| *239001 | ---- | Arm with 202135 |
| 202247 | 16778 | " Cap |
| 200278H | 16778 | " " Screw |
| 202248 | 16778 | " " " Washer |
| 204235 | 16758 | " Position Pin (2) |
| 200010E | 16758 | " Screw (2) |
| 200004E | 16758 | " Screw |
| 202005 | 16758 | " " Washer (3) |
| 237702 | 16778 | " Shaft with 224392 and 350431E |

| No. | Plate | Name |
|--|-------|--|
| 237748 | 16778 | Arm Shaft Bushing (back) with 202260 |
| 202260 | 16778 | " " " " Oil Packing (wick) |
| 200071E | 16778 | Arm Shaft Bushing (back) Screw (3) |
| 239062 | 16778 | " " " (front) with 202244 |
| 202244 | 16778 | " " " " Oil Packing (wick) |
| 200502H | 16778 | Arm Shaft Bushing (front) Oil Packing Thumb Screw |
| 200338C | 16778 | Arm Shaft Bushing (front) Set Screw |
| 224392 | 16778 | " " Oil Packing (wick) |
| 350431E | 16778 | " " " " Stop Screw |
| 202632 | 16758 | " Side Plate |
| 200462H | 16758 | " " " Thumb Screw |
| 237793 | 16778 | Balance Wheel (aluminum alloy casting) for "V" belt (outside diameter of belt groove 2.9 in.) with 350540C and 350541C |
| 350419H | 16778 | Balance Wheel Adjusting Screw |
| 350540C | 16778 | " " Position Screw |
| 350541C | 16778 | " " Set Screw |
| *239002 | ----- | Bed (cylinder) |
| 239003 | 16782 | " " End Cover |
| 213312 | 16782 | " Base (4 in. high) |
| 213313 | 16782 | " " (6 in. high) |
| Note: Bed Base 213313 is furnished with this machine unless otherwise specified on order | | |
| 203184 | 16782 | Bed Clamp |
| 200262H | 16782 | " " Hinge Screw |
| 202622 | 16782 | " " Packing Washer |
| 200728H | 16782 | " " Thumb Screw |
| 203185 | 16782 | " " Washer |
| 202618 | 16782 | " Hinge |
| 201110H | 16782 | " " Screw (6) |
| 213338 | 16782 | " Slide (back) |
| 239004 | 16782 | " " " Clamp Plate (back) |
| 239005 | 16782 | " " " " (front) |
| 200580H | 16782 | " " " " Screw (4) |
| 203470 | 16780 | Bobbin |
| *235099 | ----- | " Case |
| 203648 | 16780 | " " Latch |
| *202056 | ----- | " " " Pin |
| 203473 | 16780 | " " " Plunger |
| 203474 | 16780 | " " " Spring |
| 239006 | 16780 | " " Lever |
| *203476 | ----- | " " " Eccentric |
| 204243 | 16780 | " " " " Position Pin |
| 203577 | 16780 | " " " Fulcrum with 203579 |
| 200110D | 16780 | " " " " Screw |
| 203578 | 16780 | " " " Slide |
| 203579 | 16780 | " " " Stud |
| 241674 | 16780 | " " " Tension Spring |

| No. | Plate | Name |
|---------|-------|---|
| 241675 | 16780 | Bobbin Case Oiling Felt Retainer |
| 350405C | 16780 | " " " " " Screw |
| 203214 | 16780 | " " Tension Spring |
| 200984C | 16780 | " " " " Regulating Screw |
| 200594C | 16780 | Bobbin Case Tension Spring Screw |
| 203216 | 16780 | " " Washer (cloth) |
| 235100 | 16780 | Bobbin Case complete, Nos. 200594C, 200984C, 202056, 203214, 203216, 203473, 203474, 203648, 235099, 241674, 241675 and two 350405C |
| 239007 | 16780 | Cylinder End Cover Rest |
| 200110D | 16780 | " " " " Screw |
| 239070 | 16758 | Face Plate with 201650H and 350432XC |
| 202135 | 16758 | " " Position Pin |
| 200473H | 16758 | " " Thumb Screw |
| 239009 | 16779 | Feed Driving Gear Shaft |
| 239028 | 16779 | " " " " Bushing (back) |
| 239010 | 16779 | " " " " (front) |
| 200347C | 16779 | " " " " Set Screw (back) |
| 200335C | 16779 | Feed Driving Gear Shaft Bushing Set Screw (front) |
| 221743 | 16779 | Feed Driving Gear Shaft Collar with two 200380C |
| 200380C | 16779 | Feed Driving Gear Shaft Collar Set Screw |
| 239020 | 16779 | Feed Driving Gear Shaft Driving Gear, 25 teeth, with 200382C and 201220C, for 12-1/2 to 23 stitches per inch |
| 239013 | 16779 | Feed Driving Gear Shaft Driving Gear Guard |
| 200030H | 16779 | Feed Driving Gear Shaft Driving Gear Guard Screw |
| 201220C | 16779 | Feed Driving Gear Shaft Driving Gear Position Screw |
| 200382C | 16779 | Feed Driving Gear Shaft Driving Gear Set Screw |
| 239015 | 16779 | Feed Driving Gear Shaft Pinion, 19 teeth, with 200382C and 201220C |
| 201220C | 16779 | Feed Driving Gear Shaft Pinion Position Screw |
| 200382C | 16779 | Feed Driving Gear Shaft Pinion Set Screw |
| 237724 | 16779 | Feed Driving Worm Gear with 200378C and 201220C |
| 201220C | 16779 | Feed Driving Worm Gear Position Screw |
| 200378C | 16779 | Feed Driving Worm Gear Set Screw |
| 239016 | 16779 | " " " " Shaft |
| 239017 | 16779 | " " " " Bushing |

| No. | Plate | Name |
|----------|-------|--|
| 200346C | 16754 | Feed Driving Worm Gear Shaft Bushing Set Screw |
| 239027 | 16779 | Feed Regulating Counter Shaft |
| 239028 | 16779 | " " " " Bushing |
| 200363AL | 16779 | " " " " Set Screw |
| 239021 | 16779 | Feed Regulating Counter Shaft Gear, 26 teeth, with 200382C and 201220C |
| 201220C | 16779 | Feed Regulating Counter Shaft Gear Position Screw |
| 200382C | 16779 | Feed Regulating Counter Shaft Gear Set Screw |
| 239023 | 16779 | Feed Regulating Gear, 28 teeth, with 200382C and 201220C |
| 201220C | 16779 | Feed Regulating Gear Position Screw |
| 200382C | 16779 | " " " Set Screw |
| 239029 | 16779 | " Wheel |
| 239030 | 16779 | " " Bracket |
| 200437C | 16779 | " " " Adjusting Screw (back) |
| 200437C | 16779 | Feed Wheel Bracket Adjusting Screw (front) |
| 200388C | 16779 | Feed Wheel Bracket Adjusting Screw Check Screw (back or front) (2) |
| 239031 | 16780 | Feed Wheel Bracket Position Plate |
| 200156E | 16780 | " " " " " Screw |
| 239032 | 16779 | Feed Wheel Gear |
| 200083E | 16779 | " " " Screw (2) |
| 239040 | 16758 | Foot Lifter Lifting Lever |
| 200262H | 16758 | " " " " Hinge Screw |
| 239063 | 16758 | " " " " Spring |
| 200835D | 16758 | " " " " " Screw |
| *203482 | ----- | Hook (sewing) |
| 237726 | 16780 | " 203482 with 201253F, 201376C and 221148 |
| 239076 | 16780 | Hook and Bobbin Case complete, Nos. 235100 and 237726 |
| 203596 | 16780 | Hook Bevel Gear Socket, 18 teeth |
| 239033 | 16780 | " " " " Bushing |
| 200446C | 16780 | " " " " " Position Screw |
| 200556H | 16780 | Hook Bevel Gear Socket Screw |
| 239034 | 16779 | " " Pinion with two 350171C |
| 350171C | 16779 | " " " Set Screw |
| 239035 | 16779 | " Driving Shaft |
| 235857 | 16779 | " " " Bevel Gear with 200374C and 200396C |
| 239036 | 16754 | Hook Driving Shaft Bevel Gear Housing with three 200346C |
| 237730 | 16754 | Hook Driving Shaft Bevel Gear Housing Cap (bottom) |

| No. | Plate | Name |
|----------|-------|--|
| 237731 | 16754 | Hook Driving Shaft Bevel Gear Housing Cap (bottom) Gasket |
| 237732 | 16754 | Hook Driving Shaft Bevel Gear Housing Cap (side) |
| 237733 | 16754 | Hook Driving Shaft Bevel Gear Housing Cap (side) Gasket |
| 200053C | 16754 | Hook Driving Shaft Bevel Gear Housing Cap Screw (4) |
| 201082E | 16754 | Hook Driving Shaft Bevel Gear Housing Screw (long) |
| 225532 | 16754 | Hook Driving Shaft Bevel Gear Housing Screw (long) Washer |
| 201308E | 16754 | Hook Driving Shaft Bevel Gear Housing Screw (short) |
| 203637 | 16754 | Hook Driving Shaft Bevel Gear Housing Screw (short) Washer |
| 200396C | 16779 | Hook Driving Shaft Bevel Gear Position Screw |
| 200374C | 16779 | Hook Driving Shaft Bevel Gear Set Screw |
| 239037 | 16779 | Hook Driving Shaft Bushing (back) |
| 200346C | 16754 | " " " " " Set Screw |
| 239038 | 16779 | Hook Driving Shaft Bushing (front) |
| 200363AL | 16779 | " " " " " Set Screw |
| 221743 | 16779 | Hook Driving Shaft Collar with two 200380C |
| 200380C | 16779 | Hook Driving Shaft Collar Set Screw |
| 221148 | 16780 | " Gib |
| 201376C | 16780 | " " Hinge Screw |
| 201253F | 16780 | " " Screw |
| 239039 | 16780 | " Saddle with 200446C |
| 350175E | 16780 | " " " Screw (2) |
| 225837 | 16780 | " " " Washer (2) |
| 213018 | 16780 | " Washer with 203476 and three 204243 |
| 237937 | 16755 | Needle Bar with 200141F |
| 239041 | 16755 | " " Connecting Link |
| 239042 | 16755 | " " " " " Oil Guard |
| 201183D | 16755 | " " " " " " Screw |
| 202333 | 16755 | Needle Bar Connecting Link Stud with 202254 |
| 202254 | 16755 | Needle Bar Connecting Link Stud Oil Packing (wick) |
| 200374C | 16755 | Needle Bar Connecting Link Stud Set Screw |
| 200383C | 16755 | Needle Bar Connecting Link Stud Set Screw |
| *206891 | ----- | Needle Bar Connecting Stud |

| No. | Plate | Name |
|---------|-------|---|
| 202329 | 16755 | Needle Bar Connecting Stud 206891 with 200086C and 202330 |
| 202330 | 16755 | Needle Bar Connecting Stud Oil Packing (wick) |
| 200086C | 16755 | Needle Bar Connecting Stud Pinch Screw |
| 202692 | 16755 | " " Crank with 200335C, 200374C, 200383C, 200428C and 202333 |
| 239043 | 16755 | Needle Bar Crank 202692 with 202329, 202399, 202400, 239041 and 239049 |
| 203172 | 16755 | Needle Bar Crank Friction Washer |
| 200428C | 16755 | " " " Position Screw |
| 200335C | 16755 | " " " Set Screw |
| 239044 | 16755 | " " Rock Frame |
| 239045 | 16755 | " " " " 239044 with 237937 |
| *237794 | ----- | Needle Bar Rock Frame Driving Eccentric |
| *237749 | ----- | Needle Bar Rock Frame Driving Eccentric Body |
| 350107C | 16778 | Needle Bar Rock Frame Driving Eccentric Body Position Screw |
| 443C | 16778 | Needle Bar Rock Frame Driving Eccentric Body Set Screw |
| 1103C | 16778 | Needle Bar Rock Frame Driving Eccentric Regulating Screw |
| 217D | 16778 | Needle Bar Rock Frame Driving Eccentric Set Screw |
| 7071 | 16778 | Needle Bar Rock Frame Driving Eccentric Set Screw Washer |
| 237750 | 16778 | Needle Bar Rock Frame Driving Eccentric complete, Nos. 217D, 443C, 1103C, 7071, 237749, 237794 and 350107AL |
| 237739 | 16754 | Needle Bar Rock Frame Driving Fork Lever with 200029E |
| 200029E | 16754 | Needle Bar Rock Frame Driving Fork Lever Pinch Screw |
| 237740 | 16754 | Needle Bar Rock Frame Driving Fork Lever Slide Block (two pieces) |
| 210910 | 16755 | Needle Bar Rock Frame Hinge Stud with 202277 |
| 202277 | 16755 | Needle Bar Rock Frame Hinge Stud Oil Packing (wick) |
| 200347C | 16755 | Needle Bar Rock Frame Hinge Stud Set Screw |
| 202666 | 16755 | Needle Bar Rock Frame Position Bracket |
| 200098F | 16755 | Needle Bar Rock Frame Position Bracket Screw |
| 202667 | 16754 | Needle Bar Rock Frame Rock Shaft |
| 210978 | 16754 | " " " " " " |
| | | 202667 with 200387C and 210920 |

| No. | Plate | Name |
|---------|-------|---|
| 202668 | 16754 | Needle Bar Rock Frame Slide Block |
| 210920 | 16754 | " " " " " " |
| | | 202668 with 201141C |
| 201141C | 16754 | Needle Bar Rock Frame Slide Block Screw Stud |
| 200387C | 16754 | Needle Bar Rock Frame Slide Block Screw Stud Set Screw |
| 200141F | 16755 | Needle Set Screw |
| 207072 | 16781 | Presser Bar Bushing (2) |
| 200352C | 16781 | " " " Set Screw (2) |
| 202671 | 16781 | " " " Lifter |
| 200653C | 16781 | " " " Hinge Screw |
| 239046 | 16781 | " " " Lifting Releasing Lever Bracket |
| 200975F | 16781 | Presser Bar Lifting Releasing Lever Bracket Guide Screw |
| 206608 | 16781 | Presser Bar Lifting Releasing Lever Bracket Spring |
| 202337 | 16781 | Presser Bar Position Guide |
| 202338 | 16781 | " " " " Lever with 200086F |
| 200086F | 16781 | Presser Bar Position Guide Lever Pinch Screw |
| 200352C | 16781 | Presser Bar Position Guide Set Screw |
| 239069 | 16758 | " " " Spring (flat) |
| 239048 | 16781 | " " " Bracket with 200086C |
| 200086C | 16781 | " " " " Pinch Screw |
| 350346C | 16758 | Presser Bar Spring Regulating Screw |
| 200948F | 16758 | " " " Support Screw |
| 201954 | 17635 | Roller Presser, 13/16 in. diam., 1/8 in. face, with 1528J, 201699C, 350104C and twenty-eight 206417 |
| 203422 | 17635 | Roller Presser Arm |
| 237816 | 17635 | " " " 203422 with 201954 |
| 233807 | 16781 | " " " Bracket |
| 235088 | 16781 | " " " " Position Collar with 200362C |
| 200117F | 16781 | Roller Presser Arm Bracket Position Collar Position Screw |
| 200362C | 16781 | Roller Presser Arm Bracket Position Collar Set Screw |
| 202558 | 16781 | Roller Presser Arm Bracket Spring |
| 202559 | 16781 | " " " " " " Stop |
| 200141F | 16781 | " " " " " " " Screw |
| 200096D | 16781 | Roller Presser Arm Screw |
| 206417 | 17635 | " " " Ball, 1/16 in. diameter |
| 201699C | 17635 | " " " Cone |
| 202557 | 16781 | " " " Bar |
| 350104C | 17635 | " " " Hinge Screw |
| 1528J | 17635 | " " " " Nut |

| No. | Plate | Name |
|---------|-------|--|
| 237847 | 16781 | Roller Presser and Bar complete, Nos. 200096D, 200117F, 202557 to 202559, 233807, 235088, 237816 and two 200141F |
| 202068 | 16778 | Spool Holder Base |
| 200575H | 16778 | " " " Screw |
| 204296 | 16778 | " " " Wire |
| 200079H | 16778 | " " " Hinge Screw |
| 204297 | 16778 | Spool Holder complete, Nos. 200079H, 202068 and 204296 |
| 239049 | 16755 | Take-up Lever |
| 202399 | 16755 | " " " Driving Stud with 202277 |
| 202277 | 16755 | " " " " Oil Packing (wick) |
| 202400 | 16755 | Take-up Lever Hinge Stud with 202423 |
| 202423 | 16755 | " " " " Oil Packing (wick) |
| 200363C | 16755 | Take-up Lever Hinge Stud Set Screw |
| 202401 | 16781 | " " " Oiling Felt |
| 200132E | 16781 | " " " " Screw |
| 244048 | 16757 | Tension Disc (back) |
| 239061 | 16757 | " " (front) |
| 210950 | 16757 | " Release Driving Lever with 200394C and 202676 |
| 202676 | 16781 | Tension Release Driving Lever Pin |
| 239050 | 16757 | " " " " Slide Bar |
| 239051 | 16757 | Tension Release Driving Lever Pin Slide Bar 239050 with 200167E and 239055 |
| 202678 | 16757 | Tension Release Driving Lever Pin Slide Bar Spring |
| 200394C | 16781 | Tension Release Driving Lever Set Screw |
| 239052 | 16757 | Tension Release Washer |
| 202407 | 16757 | " Spring |
| 263106 | 16757 | " " Washer |
| 200625F | 16757 | " Stud with 204925 |
| 200061C | 16757 | " " Set Screw |
| 204925 | 16757 | " " Washer |
| 201572H | 16757 | " Thumb Nut |
| 239053 | 16757 | Tension complete, Nos. 200625F, 201572H, 202407, 239052, 239054, 239061, 244048 and 263106 |
| 239054 | 16757 | Thread Controller Spring |
| 239055 | 16757 | " " " Stop |
| 200167E | 16757 | " " " " Screw |
| 210955 | 16757 | " Guide (upper) |
| 200582H | 16757 | " " Screw (2) |
| 241755 | 16758 | " Lubricator Oil Pad (felt) |
| 237779 | 16758 | " " " Holder |
| 240439 | 16758 | " " " " Retainer |
| 239071 | 16758 | " " " Reservoir (left) |
| | | Hand |

| No. | Plate | Name |
|----------|-------|--|
| 241759 | 16758 | Thread Lubricator Oil Wick |
| 350432XC | 16758 | " " " Screw |
| 201650H | 16758 | " " " " Nut |
| 214838 | 16758 | " " " " Washer |
| 239072 | 16758 | Thread Lubricator (left hand) complete, Nos. 214838, 237779, 239071, 240439, 241755 and 241759 |
| 223710 | 16757 | Thread Retainer Bracket with 200397H |
| 200582H | 16757 | " " " " Screw (2) |
| 210960 | 16757 | " " " Disc |
| 210961 | 16757 | " " " Plunger |
| 210962 | 16757 | " " " " Spring |
| 210993 | 16757 | " " " Sleeve |
| 239056 | 16757 | " " " Socket |
| 200397H | 16757 | " " " " Set Screw |
| 223844 | 16757 | " " " Spring |
| 210957 | 16757 | " " " Stud |
| 210958 | 16757 | " " " " Collar |
| 200397H | 16757 | " " " " Set Screw |
| 223711 | 16757 | Thread Retainer (lower) complete, Nos. 210957, 210958, 210993, 223710 and 223844 |
| 239057 | 16782 | Throat Plate, 53 elongated needle hole, for needle sizes 14 and 15 |
| 200577A1 | 16782 | Throat Plate Screw (2) |
| 237744 | 16754 | Vertical Shaft |
| 237745 | 16754 | " " Bevel Gear (lower) |
| 205508 | 16754 | " " " " " " Position Pin |
| 235857 | 16754 | Vertical Shaft Bevel Gear (upper) with 200374C and 200396C |
| 200396C | 16754 | Vertical Shaft Bevel Gear (upper) Position Screw |
| 200374C | 16754 | Vertical Shaft Bevel Gear (upper) Set Screw |
| 237734 | 16754 | Vertical Shaft Bushing (lower) |
| 200346C | 16754 | " " " " " Set Screw |
| 237746 | 16754 | " " " " (upper) |
| 200362C | 16754 | " " " " " Set Screw |
| 237747 | 16778 | " " " Driving Gear with 200374C and 200396C |
| 200396C | 16778 | Vertical Shaft Driving Gear Position Screw |
| 200374C | 16778 | Vertical Shaft Driving Gear Set Screw |
| 237754 | 16754 | " " " Oil Leader (lower) (brass) |
| 237755 | 16754 | " " " " (upper) (brass) |

ACCESSORIES

| No. | Plate | Name |
|--------|-------|---|
| 203470 | 16780 | Bobbin (2) |
| 4822 | 17635 | Roller Presser Hinge Screw Nut Wrench |
| 228476 | 16783 | Screw Driver (Bobbin Case) |
| 16 x 4 | ----- | Needles, three each, sizes 12 and 14 |
| 227104 | 16762 | Drip Pan (cast iron, square) with one wood screw 1-1/2 in., No. 14, R. H. B. |
| 51078 | 16783 | Machine Bolt (4) |
| 6055 | 16783 | " " Washer (4) |
| 41401 | 16783 | " Rest Pin (wood) |
| 120342 | 16783 | Oiler (copper plated) with 120343 |
| 120343 | 16783 | " Spout, 3-1/2 in. long |
| 225498 | 16783 | Screw Driver (7-1/4 in. long) |
| 225554 | 16783 | Wrench (steel) |

BOBBIN WINDER

(SWINGING AUTOMATIC, LEFT HAND)

| | | |
|---------|-------|---|
| 227149 | 16761 | Base |
| 227209 | 16761 | Frame with 200125F |
| 227152 | 16761 | " Hinge Pin |
| 227153 | 16761 | " Spring |
| 200125F | 16761 | " Stop Screw |
| 227154 | 16761 | Pulley (large) with 200380C |
| 200380C | 16761 | " Set Screw |
| 227156 | 16761 | Spindle |
| 227157 | 16761 | Stop Latch |
| 227159 | 16761 | " " Hinge Pin |
| 227160 | 16761 | " " Spring |
| 227048 | 16761 | Bobbin Winder complete (large pulley) Nos. 227149, 227152 to 227154, 227156, 227157, 227159, 227160, 227209 and two round head wood screws 3/4 in., No. 12. |
| 202480 | 16761 | Spool Holder Base with 200355H and 202484 |
| 202481 | 16761 | Spool Holder Base Spool Pin |
| 202482 | 16761 | " " Tension Disc (lower or upper) |
| 200011D | 16761 | Spool Holder Tension Disc Screw |
| 200355H | 16761 | " " " " " " Set Screw |

| No. | Plate | Name |
|--------|-------|---|
| 202483 | 16761 | Spool Holder Tension Disc Spring (brass) |
| 202484 | 16761 | Spool Holder Tension Disc Thread Guide |
| 202485 | 16761 | Bobbin Winder Spool Holder complete, Nos. 200011D, 202480, 202481, 202483, two 202482 and one wood screw 1 in., No. 12 |
| 227514 | 16761 | Bobbin Winder and Spool Holder com- plete, Nos. 202485 and 227048 |

FOOT LIFTER

| | | |
|--|-------|---|
| 227952 | 16762 | Foot Lifter Lever with 227954 |
| 227678 | 16762 | " " " Chain, 48 in. long, with 202784 |
| 227954 | 16762 | Foot Lifter Lever Chain Hook (lower) |
| 202784 | 16762 | " " " " " (upper) |
| 225016 | 16762 | " " " Hinge Pin |
| 227939 | 16762 | " " " Stand with two wood screws 1 in., No. 12 |
| 227955 | 16762 | Foot Lifter Lever complete, Nos. 225016, 227678, 227939 and 227952 |
| (Other Foot Lifter parts are listed with parts of Machine Head) | | |

FEED REGULATING GEARS

| | | |
|--------|-------|---|
| 239018 | 16779 | Feed Regulating Gear, 23 teeth, with 200382C and 201220C |
| 239019 | 16779 | Feed Regulating Gear, 24 teeth, with 200382C and 201220C |
| 239020 | 16779 | Feed Regulating Gear, 25 teeth, with 200382C and 201220C |
| 239021 | 16779 | Feed Regulating Gear, 26 teeth, with 200382C and 201220C |
| 239022 | 16779 | Feed Regulating Gear, 27 teeth, with 200382C and 201220C |
| 239023 | 16779 | Feed Regulating Gear, 28 teeth, with 200382C and 201220C |
| 239024 | 16779 | Feed Regulating Gear, 29 teeth, with 200382C and 201220C |
| 239025 | 16779 | Feed Regulating Gear, 30 teeth, with 200382C and 201220C |
| 239026 | 16779 | Feed Regulating Gear, 31 teeth, with 200382C and 201220C |

ROLLER PRESSERS

| No. | Plate | Name |
|---------|-------|--|
| 201926 | 17635 | Roller Presser, 13/16 in. diam., 5/32 in. face (fine) with 1528J, 201699C, 350104C and twenty-eight 206417 |
| 201928 | 17688 | Roller Presser, 1-1/4 in. diam., 3/16 in. face (fine) with 1528J, 1766C, 50553C and twenty-four 16232 |
| 201931 | 17688 | Roller Presser, 1-1/4 in. diam., 1/8 in. face (fine) with 1528J, 1766C, 50553C and twenty-four 16232 |
| 201933 | 17688 | Roller Presser, 1-1/4 in. diam., 1/16 in. face (fine) with 1528J, 1766C, 50553C and twenty-four 16232 |
| 201951 | 17635 | Roller Presser, 13/16 in. diam., 3/16 in. face (fine) with 1528J, 201699C, 350104C and twenty-eight 206417 |
| 201954 | 17635 | Roller Presser, 13/16 in. diam., 1/8 in. face, with 1528J, 201699C, 350104C and twenty-eight 206417 |
| 201971 | 17688 | Roller Presser, 1-1/4 in. diam., 3/32 in. face (fine) with 1528J, 1766C, 50553C and twenty-four 16232 |
| 201963 | 17688 | Roller Presser, 1-1/4 in. diam., 5/32 in. in. face, with 1528J, 1766C, 50553C and twenty-four 16232 |
| 203422 | 17635 | Roller Presser Arm |
| 203426 | 17688 | " " Arm |
| 203423 | 17635 | " " " 203422 with 201926 |
| 203427 | 17688 | " " " 203426 with 201928 |
| 203430 | 17688 | " " " 203426 with 201931 |
| 203431 | 17688 | " " " 203426 with 201933 |
| 203432 | 17635 | " " " 203422 with 201951 |
| 203434 | 17688 | " " " 203426 with 201963 |
| 237816 | 17635 | " " " 203422 with 201954 |
| 238527 | 17688 | " " " 203426 with 201971 |
| 233807 | 17681 | " " " Bracket |
| 235088 | 17681 | " " " " Position |
| | | Collar with 200362C |
| 200117F | 16781 | Roller Presser Arm Bracket Position |
| | | Collar Position Screw |
| 200362C | 16781 | Roller Presser Arm Bracket Position |
| | | Collar Set Screw |
| 202558 | 16781 | Roller Presser Arm Bracket Spring |
| 202559 | 16781 | " " " " " |
| | | Stop |
| 200141F | 16781 | Roller Presser Arm Bracket Spring |
| | | Stop Screw |
| 200096D | 16781 | Roller Presser Arm Stop |

| No. | Plate | Name |
|---------|-------|--|
| 16232 | 17688 | Roller Presser Ball, 3/32 in. diameter |
| 206417 | 17635 | " " " 1/16 in. diameter |
| 1766C | 17688 | " " " Cone |
| 201699C | 17635 | " " " Cone |
| 202557 | 16781 | " " Bar |
| 50553C | 17688 | " " Hinge Screw |
| 350104C | 17635 | " " " Screw |
| 1528J | 17635 | " " " " Nut |
| 233808 | 16781 | Roller Presser and Bar complete, Nos. 200096D, 200117F, 202557 to 202559, 203427, 233807, 235088 and two 200141F |
| 233843 | 16781 | Roller Presser and Bar complete, Nos. 200096D, 200117F, 202557 to 202559, 203432, 233807, 235088 and two 200141F |
| 237847 | 16781 | Roller Presser and Bar complete, Nos. 200096D, 200117F, 202557 to 202559, 233807, 235088, 237816 and two 200141F |

WORK PLATE PLATFORM

| | | |
|---------|-------|--|
| 214013 | 17028 | Work Plate |
| 200990C | 17028 | " " Screw |
| 201518E | 17028 | " " " Nut |
| 239067 | 17028 | " " Slide (back) |
| 239066 | 17028 | " " " (front) |
| 239064 | 17028 | " " Yoke with 200729A |
| 200729A | 17028 | " " " Screw |
| 239065 | 17028 | Work Plate complete, Nos. 214013, 239064, 239066, 239067, four 200990C and eight 201518E |

SINGER Needles should be used
in SINGER Machines
These Needles and their Containers
are marked with the
Company's Trade Mark "SIMANCO.*" 1

Needles in Containers marked
"FOR SINGER MACHINES"
are NOT **SINGER** made needles. 2

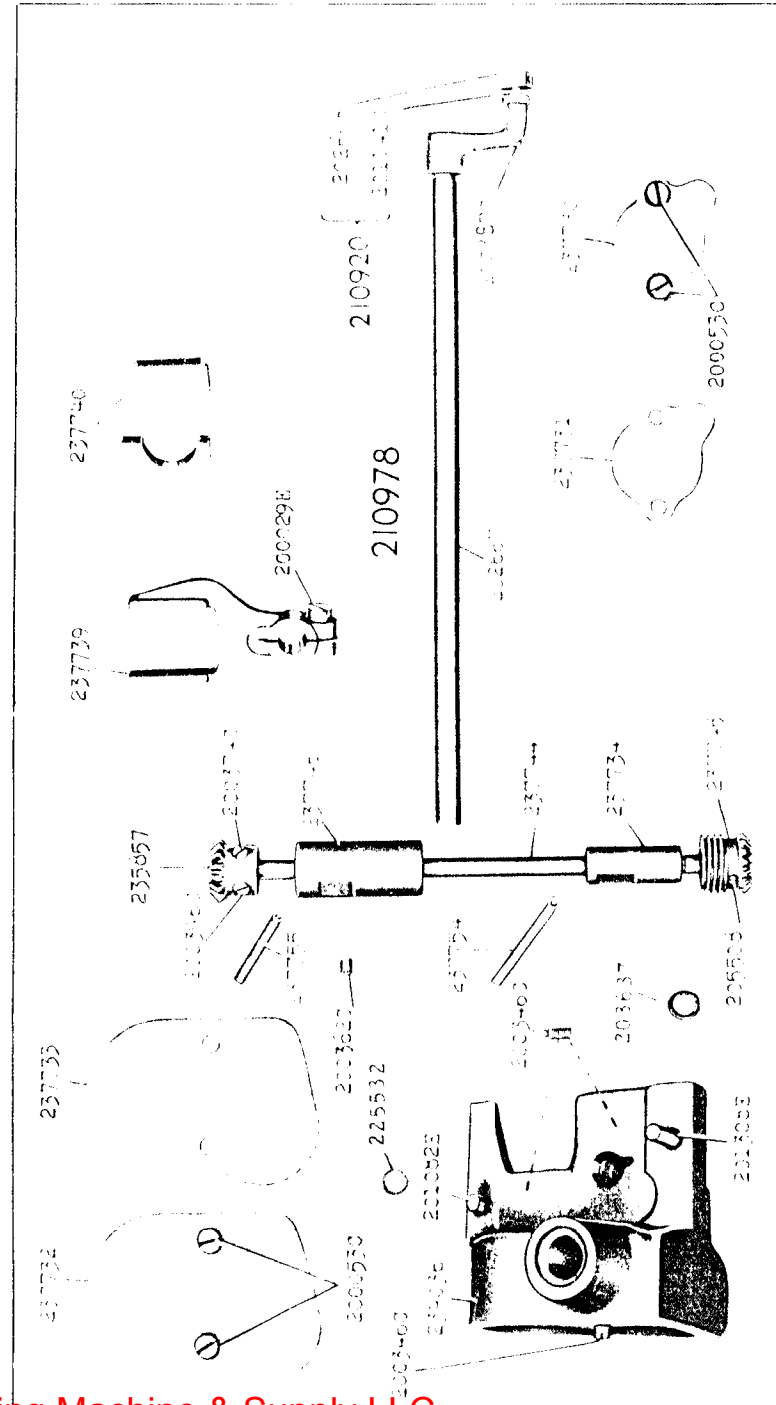

16755 - 1/2

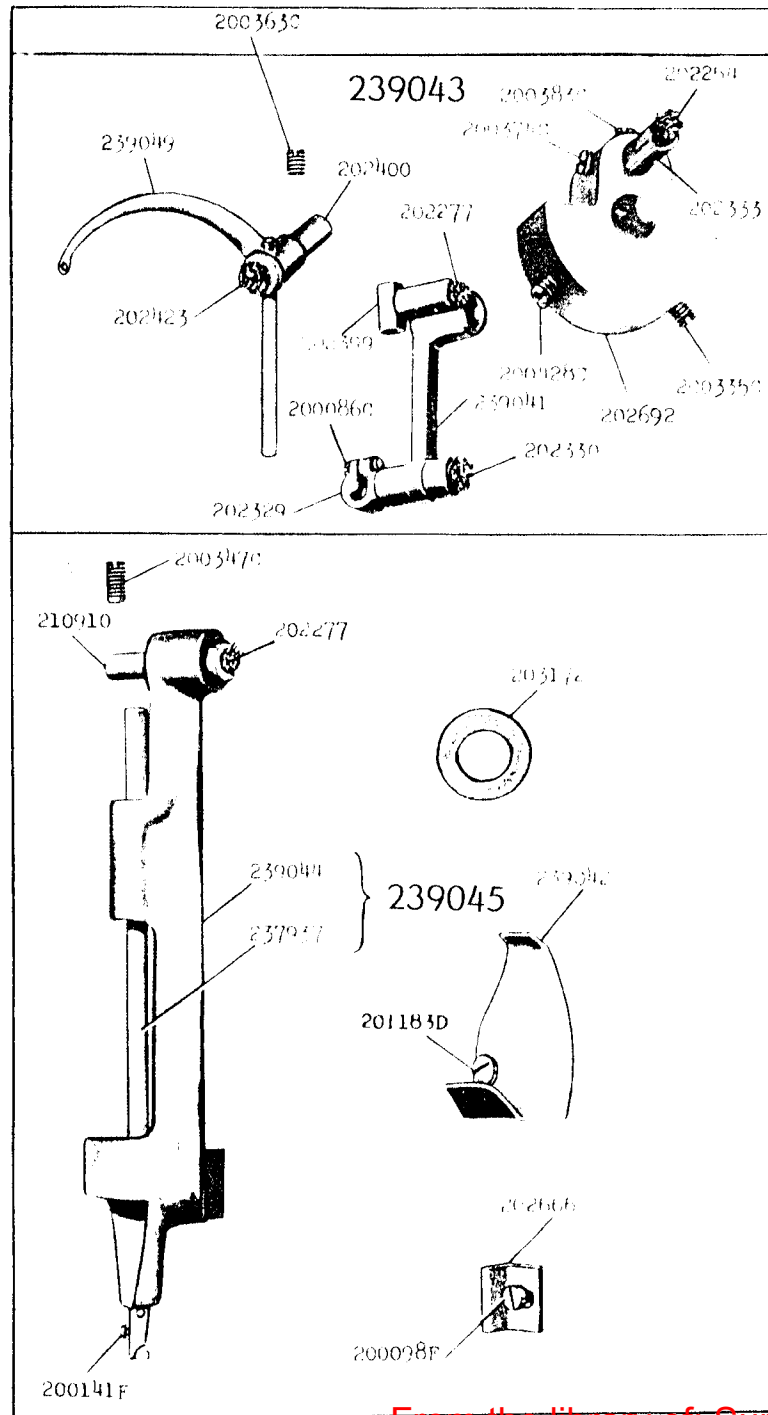

16757 - 2/3

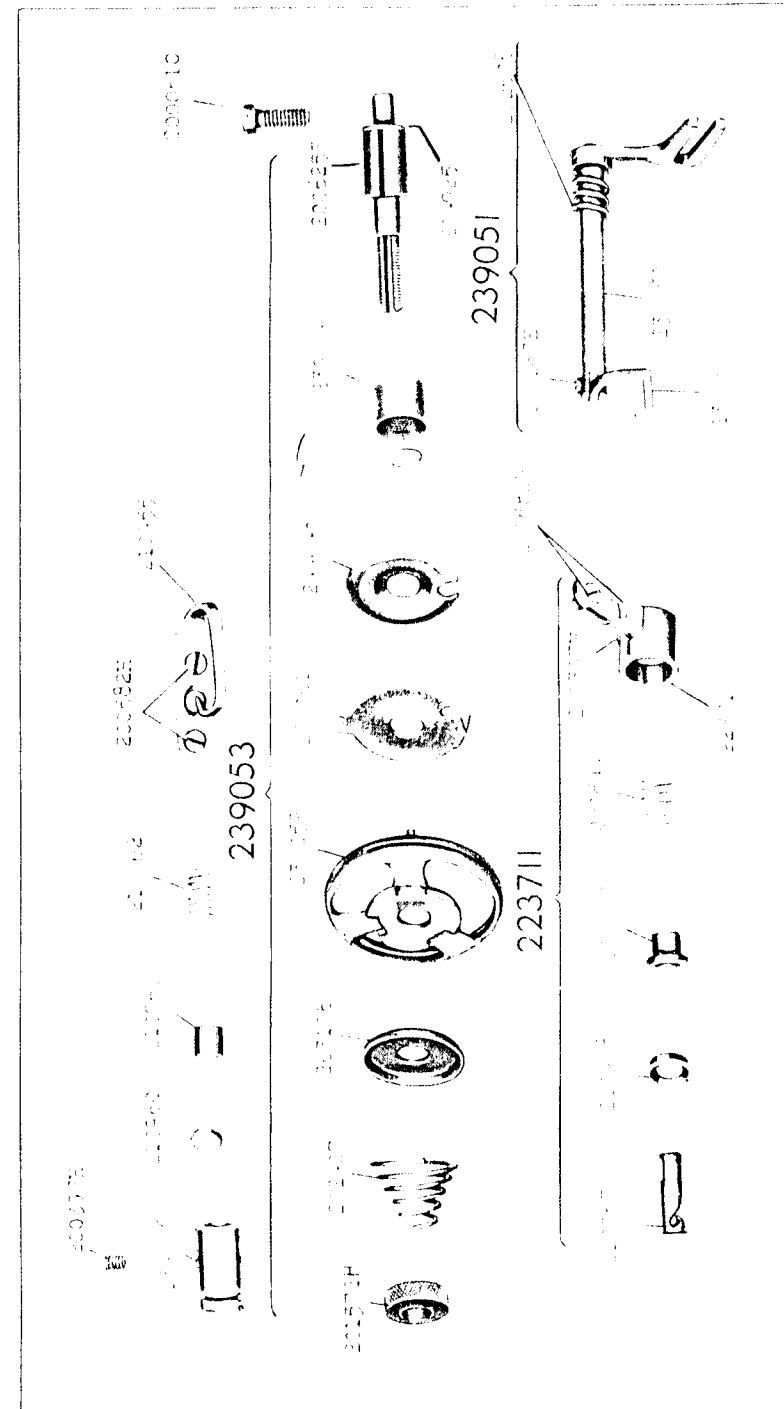

16758 - 3/8

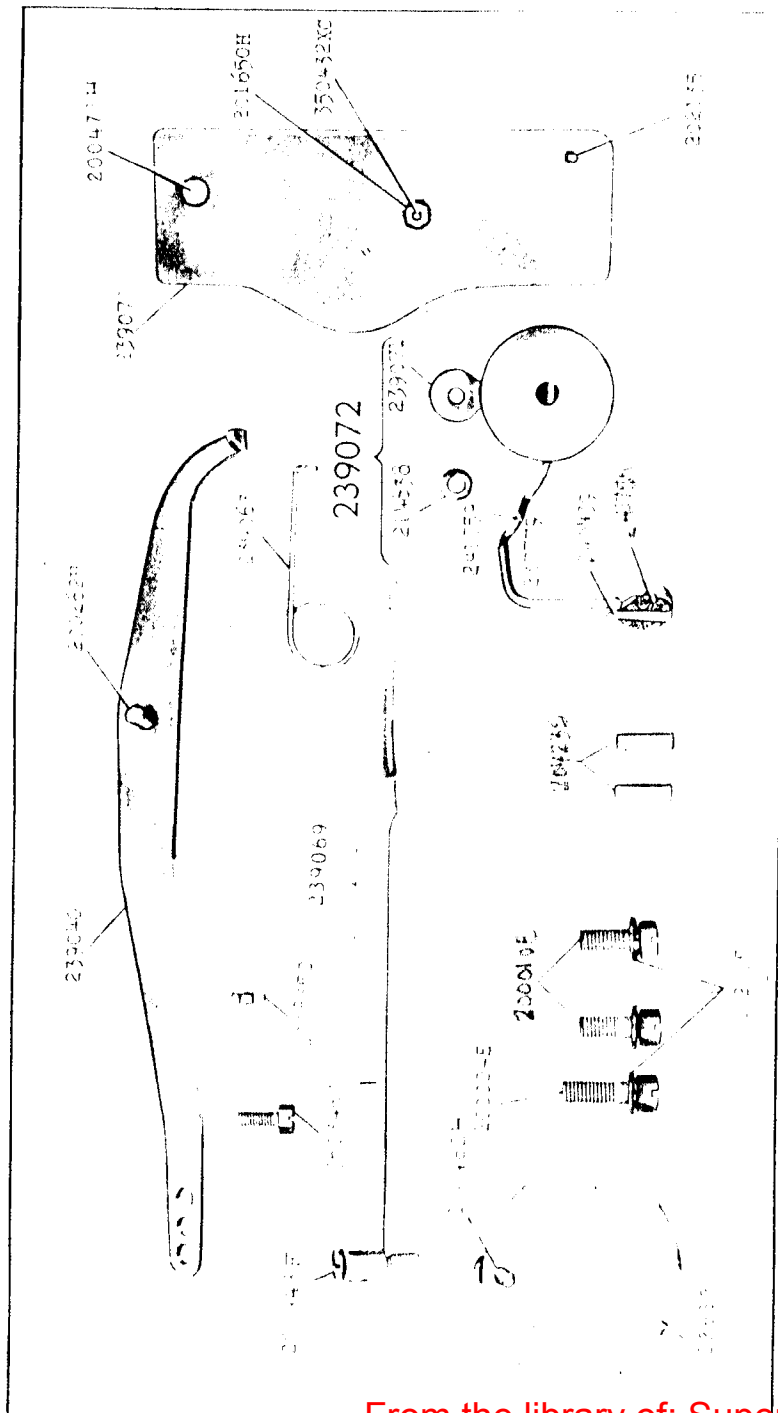

16761 - 2/3

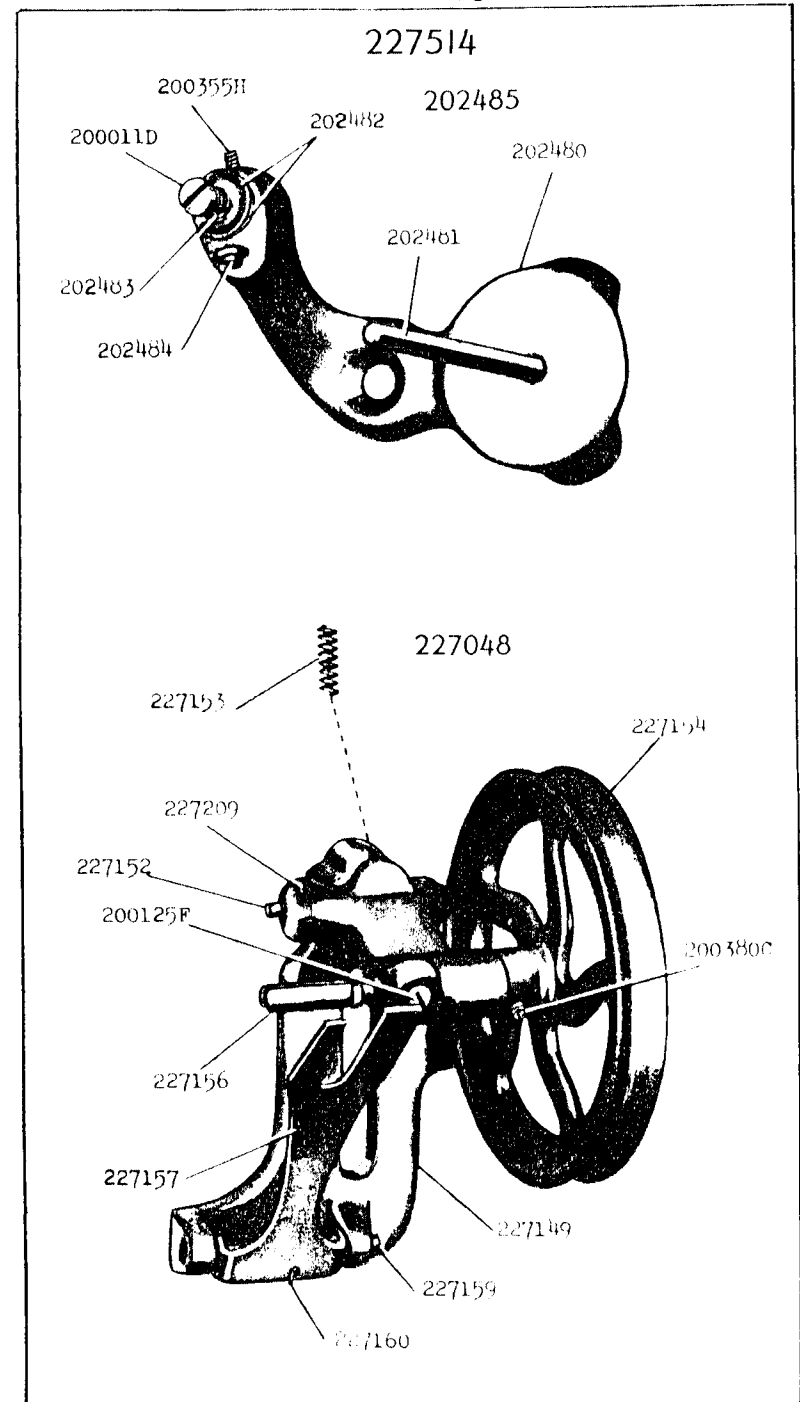

Exploded view diagram of a mechanical assembly. The diagram shows the following components and their part numbers:

- Top Assembly:**
 - 200388C (Screw)
 - 20037C (Screw)
 - 239030 (Bracket)
 - 239029 (Bracket)
 - 200683E (Bracket)
 - 200437C (Screw)
 - 239032 (Bracket)
 - 200388C (Screw)
- Central Assembly:**
 - 200385 (Screw)
 - 200386 (Screw)
 - 200387 (Screw)
 - 200388 (Screw)
 - 200389 (Screw)
 - 200390 (Screw)
 - 200391 (Screw)
 - 200392 (Screw)
 - 200393 (Screw)
 - 200394 (Screw)
 - 200395 (Screw)
 - 200396 (Screw)
 - 200397 (Screw)
 - 200398 (Screw)
 - 200399 (Screw)
 - 200400 (Screw)
 - 200401 (Screw)
 - 200402 (Screw)
 - 200403 (Screw)
 - 200404 (Screw)
 - 200405 (Screw)
 - 200406 (Screw)
 - 200407 (Screw)
 - 200408 (Screw)
 - 200409 (Screw)
 - 200410 (Screw)
 - 200411 (Screw)
 - 200412 (Screw)
 - 200413 (Screw)
 - 200414 (Screw)
 - 200415 (Screw)
 - 200416 (Screw)
 - 200417 (Screw)
 - 200418 (Screw)
 - 200419 (Screw)
 - 200420 (Screw)
 - 200421 (Screw)
 - 200422 (Screw)
 - 200423 (Screw)
 - 200424 (Screw)
 - 200425 (Screw)
 - 200426 (Screw)
 - 200427 (Screw)
 - 200428 (Screw)
 - 200429 (Screw)
 - 200430 (Screw)
 - 200431 (Screw)
 - 200432 (Screw)
 - 200433 (Screw)
 - 200434 (Screw)
 - 200435 (Screw)
 - 200436 (Screw)
 - 200437 (Screw)
 - 200438 (Screw)
 - 200439 (Screw)
 - 200440 (Screw)
 - 200441 (Screw)
 - 200442 (Screw)
 - 200443 (Screw)
 - 200444 (Screw)
 - 200445 (Screw)
 - 200446 (Screw)
 - 200447 (Screw)
 - 200448 (Screw)
 - 200449 (Screw)
 - 200450 (Screw)
 - 200451 (Screw)
 - 200452 (Screw)
 - 200453 (Screw)
 - 200454 (Screw)
 - 200455 (Screw)
 - 200456 (Screw)
 - 200457 (Screw)
 - 200458 (Screw)
 - 200459 (Screw)
 - 200460 (Screw)
 - 200461 (Screw)
 - 200462 (Screw)
 - 200463 (Screw)
 - 200464 (Screw)
 - 200465 (Screw)
 - 200466 (Screw)
 - 200467 (Screw)
 - 200468 (Screw)
 - 200469 (Screw)
 - 200470 (Screw)
 - 200471 (Screw)
 - 200472 (Screw)
 - 200473 (Screw)
 - 200474 (Screw)
 - 200475 (Screw)
 - 200476 (Screw)
 - 200477 (Screw)
 - 200478 (Screw)
 - 200479 (Screw)
 - 200480 (Screw)
 - 200481 (Screw)
 - 200482 (Screw)
 - 200483 (Screw)
 - 200484 (Screw)
 - 200485 (Screw)
 - 200486 (Screw)
 - 200487 (Screw)
 - 200488 (Screw)
 - 200489 (Screw)
 - 200490 (Screw)
 - 200491 (Screw)
 - 200492 (Screw)
 - 200493 (Screw)
 - 200494 (Screw)
 - 200495 (Screw)
 - 200496 (Screw)
 - 200497 (Screw)
 - 200498 (Screw)
 - 200499 (Screw)
 - 200500 (Screw)
 - 200501 (Screw)
 - 200502 (Screw)
 - 200503 (Screw)
 - 200504 (Screw)
 - 200505 (Screw)
 - 200506 (Screw)
 - 200507 (Screw)
 - 200508 (Screw)
 - 200509 (Screw)
 - 200510 (Screw)
 - 200511 (Screw)
 - 200512 (Screw)
 - 200513 (Screw)
 - 200514 (Screw)
 - 200515 (Screw)
 - 200516 (Screw)
 - 200517 (Screw)
 - 200518 (Screw)
 - 200519 (Screw)
 - 200520 (Screw)
 - 200521 (Screw)
 - 200522 (Screw)
 - 200523 (Screw)
 - 200524 (Screw)
 - 200525 (Screw)
 - 200526 (Screw)
 - 200527 (Screw)
 - 200528 (Screw)
 - 200529 (Screw)
 - 200530 (Screw)
 - 200531 (Screw)
 - 200532 (Screw)
 - 200533 (Screw)
 - 200534 (Screw)
 - 200535 (Screw)
 - 200536 (Screw)
 - 200537 (Screw)
 - 200538 (Screw)
 - 200539 (Screw)
 - 200540 (Screw)
 - 200541 (Screw)
 - 200542 (Screw)
 - 200543 (Screw)
 - 200544 (Screw)
 - 200545 (Screw)
 - 200546 (Screw)
 - 200547 (Screw)
 - 200548 (Screw)
 - 200549 (Screw)
 - 200550 (Screw)
 - 200551 (Screw)
 - 200552 (Screw)
 - 200553 (Screw)
 - 200554 (Screw)
 - 200555 (Screw)
 - 200556 (Screw)
 - 200557 (Screw)
 - 200558 (Screw)
 - 200559 (Screw)
 - 200560 (Screw)
 - 200561 (Screw)
 - 200562 (Screw)
 - 200563 (Screw)
 - 200564 (Screw)
 - 200565 (Screw)
 - 200566 (Screw)
 - 200567 (Screw)
 - 200568 (Screw)
 - 200569 (Screw)
 - 200570 (Screw)
 - 200571 (Screw)
 - 200572 (Screw)
 - 200573 (Screw)
 - 200574 (Screw)
 - 200575 (Screw)
 - 200576 (Screw)
 - 200577 (Screw)
 - 200578 (Screw)
 - 200579 (Screw)
 - 200580 (Screw)
 - 200581 (Screw)
 - 200582 (Screw)
 - 200583 (Screw)
 - 200584 (Screw)
 - 200585 (Screw)
 - 200586 (Screw)
 - 200587 (Screw)
 - 200588 (Screw)
 - 200589 (Screw)
 - 200590 (Screw)
 - 200591 (Screw)
 - 200592 (Screw)
 - 200593 (Screw)
 - 200594 (Screw)
 - 200595 (Screw)
 - 200596 (Screw)
 - 200597 (Screw)
 - 200598 (Screw)
 - 200599 (Screw)
 - 200600 (Screw)
 - 200601 (Screw)
 - 200602 (Screw)
 - 200603 (Screw)
 - 200604 (Screw)
 - 200605 (Screw)
 - 200606 (Screw)
 - 200607 (Screw)
 - 200608 (Screw)
 - 200609 (Screw)
 - 200610 (Screw)
 - 200611 (Screw)
 - 200612 (Screw)
 - 200613 (Screw)
 - 200614 (Screw)
 - 200615 (Screw)
 - 200616 (Screw)
 - 200617 (Screw)
 - 200618 (Screw)
 - 200619 (Screw)
 - 200620 (Screw)
 - 200621 (Screw)
 - 200622 (Screw)
 - 200623 (Screw)
 - 200624 (Screw)
 - 200625 (Screw)
 - 200626 (Screw)
 - 200627 (Screw)
 - 200628 (Screw)
 - 200629 (Screw)
 - 200630 (Screw)
 - 200631 (Screw)
 - 200632 (Screw)
 - 200633 (Screw)
 - 200634 (Screw)
 - 200635 (Screw)
 - 200636 (Screw)
 - 200637 (Screw)
 - 200638 (Screw)
 - 200639 (Screw)
 - 200640 (Screw)
 - 200641 (Screw)
 - 200642 (Screw)
 - 200643 (Screw)
 - 200644

[illegible]

16781 - 1/2

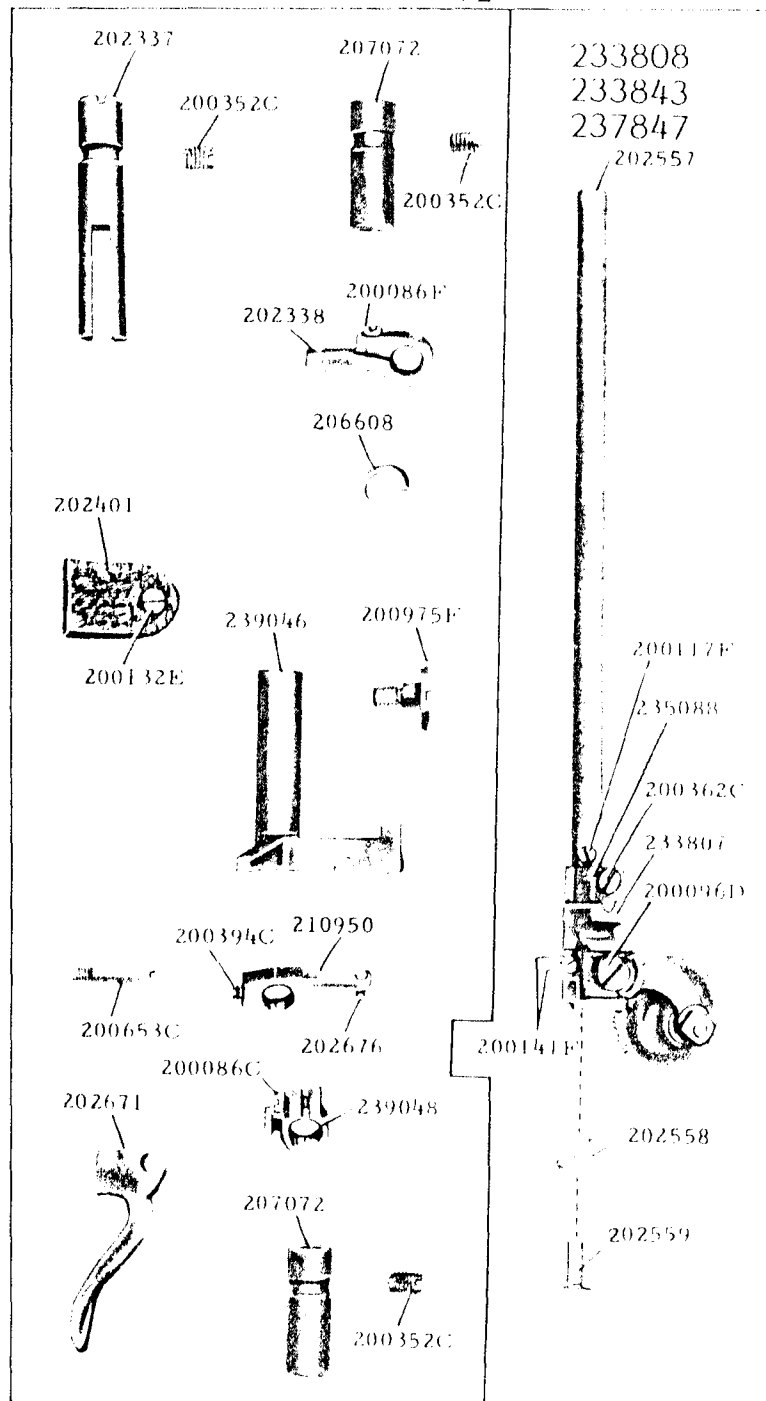

16782 - 1/3

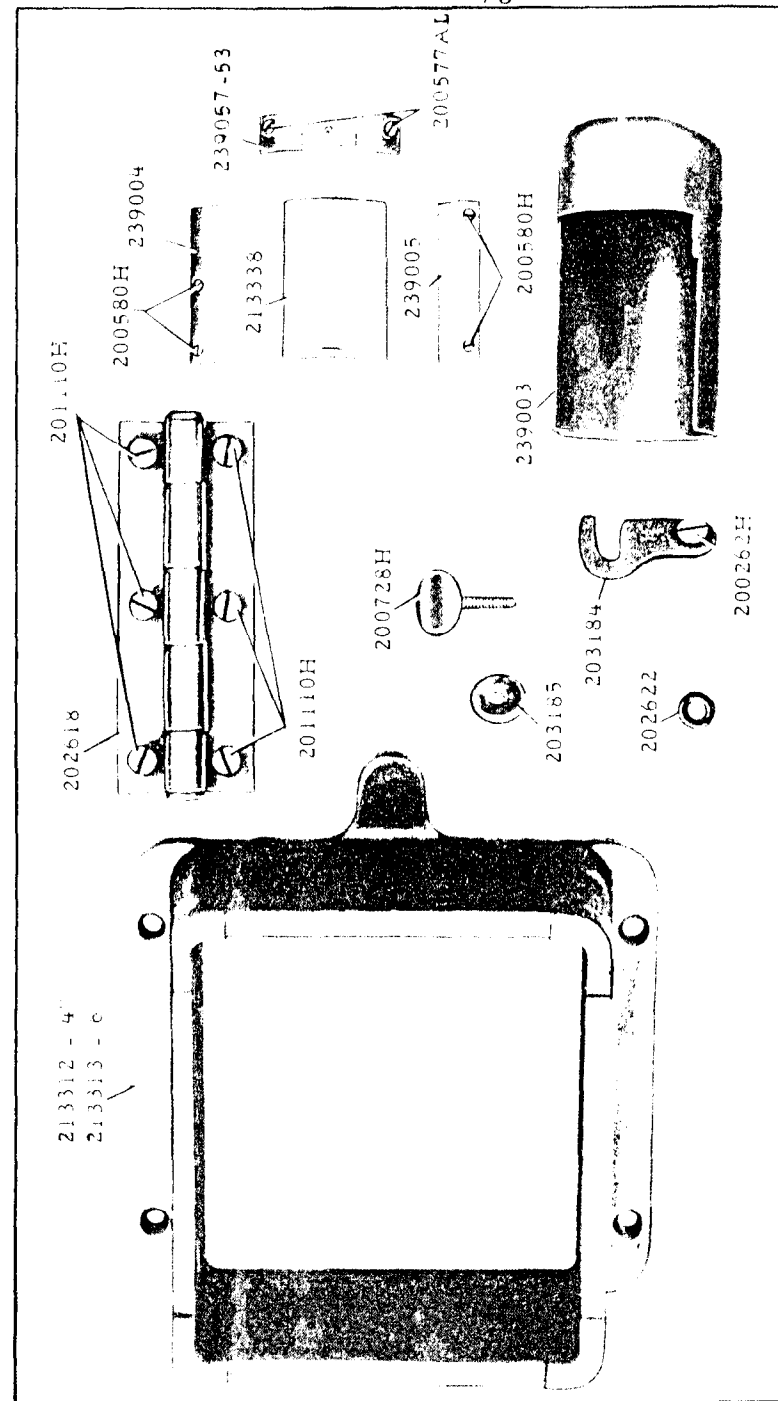

16783 - 1/2

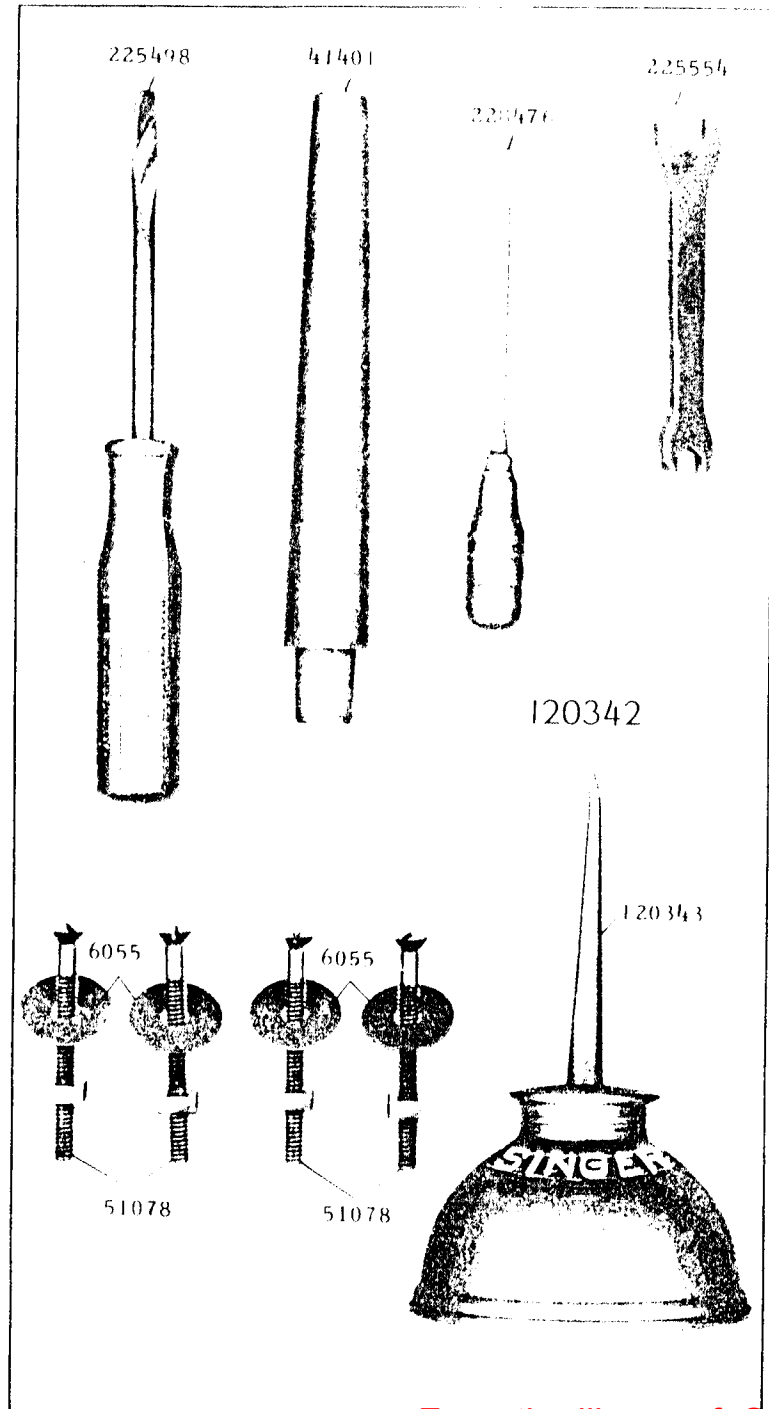

17028 - 3/8

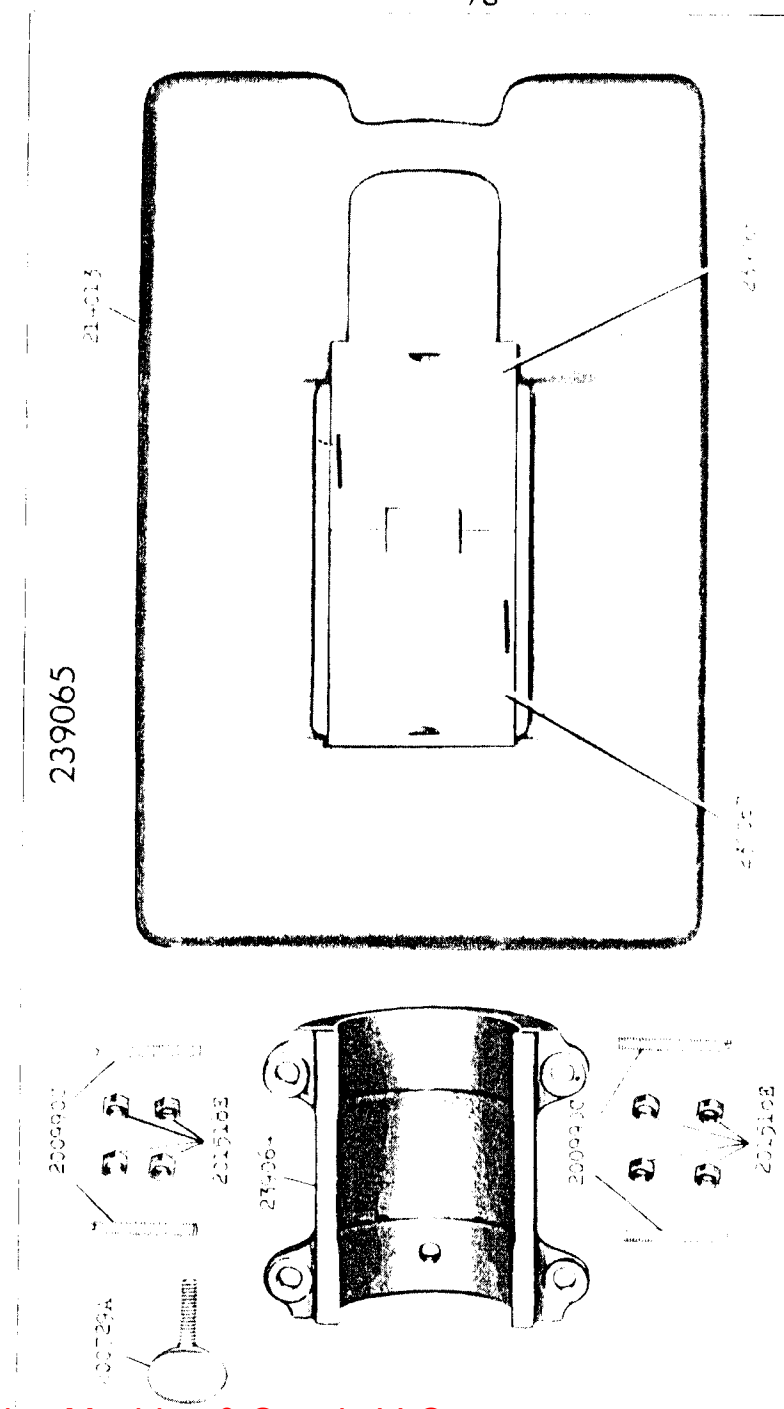

17635

237816

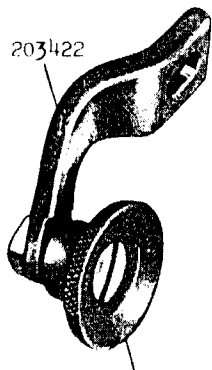

201954-13/16x1/8

203423



201926-13/16x5/32

203432

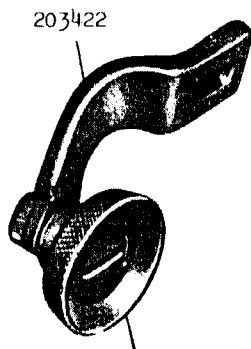

203422

201951-13/16x3/16

201699C

206417

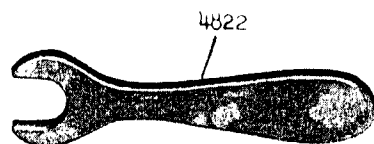
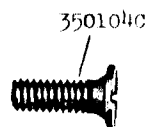

4822

17688

203434

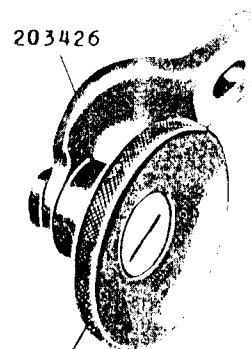

201963-1 1/4 X 5/32

238527

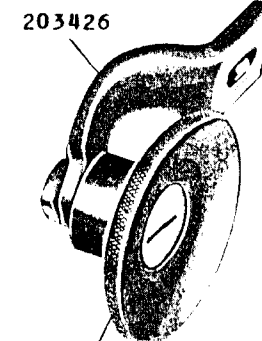

201971-1 1/4 X 3/32

203430

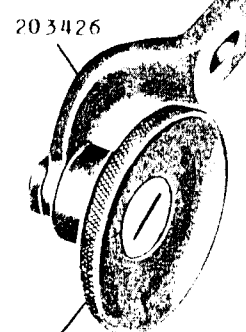

201931-1 1/4 X 1/8

203427

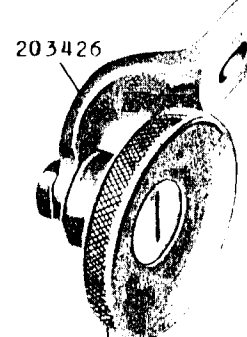

201928
1 1/4 X 3/16

203431

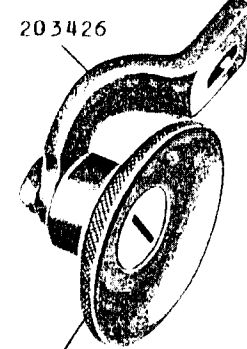

201933-1 1/4 X 1/16



16232

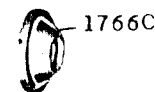

50553C

